

# PN Racing Adjustable Center Shock

- Center spring helps to off load weight of car from T-plate. T-plate can stay flat with no curvature. This gives the T-plate maximum freedom to twist for consistent roll control and better traction.
- Thru-shaft design maximize length of cylinder for smooth operation. Extra cylinder surface area increase effectiveness of damping oil or grease when used. Thru-shaft arrangement also results in constant amount of overlap between shaft and cylinder for consistent damping thru out travel.
- Adjustable coil over shock spring
- Adjustable negative spring. Addition of negative spring controls the shock during bottoming. It dampens rebound for better axel control, and minimize momentary traction loss when going over large bumps.
- Negative spring interchangeable with MR02 front springs. Therefore wide range of springs can be used for tuning.

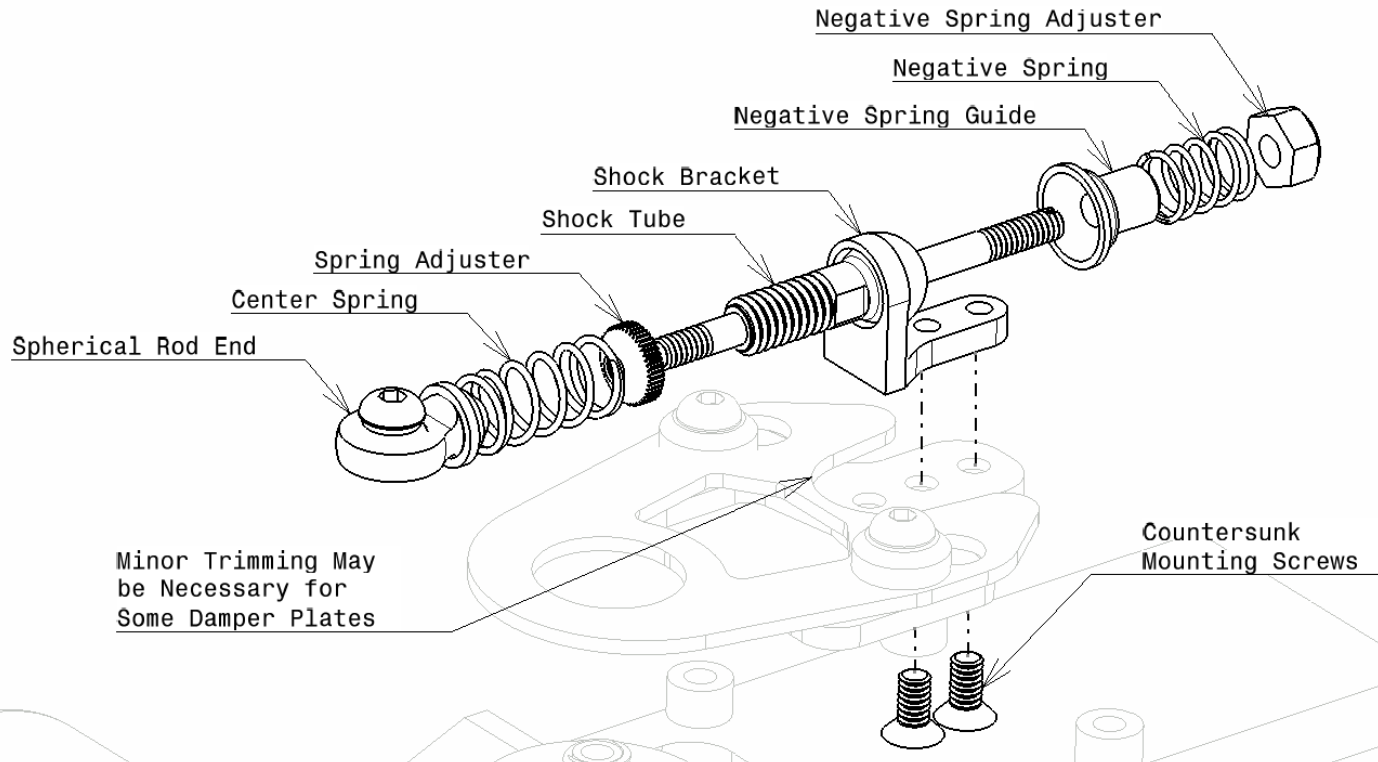

# Section View

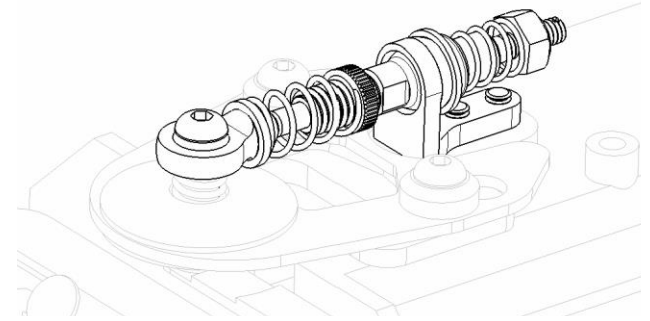
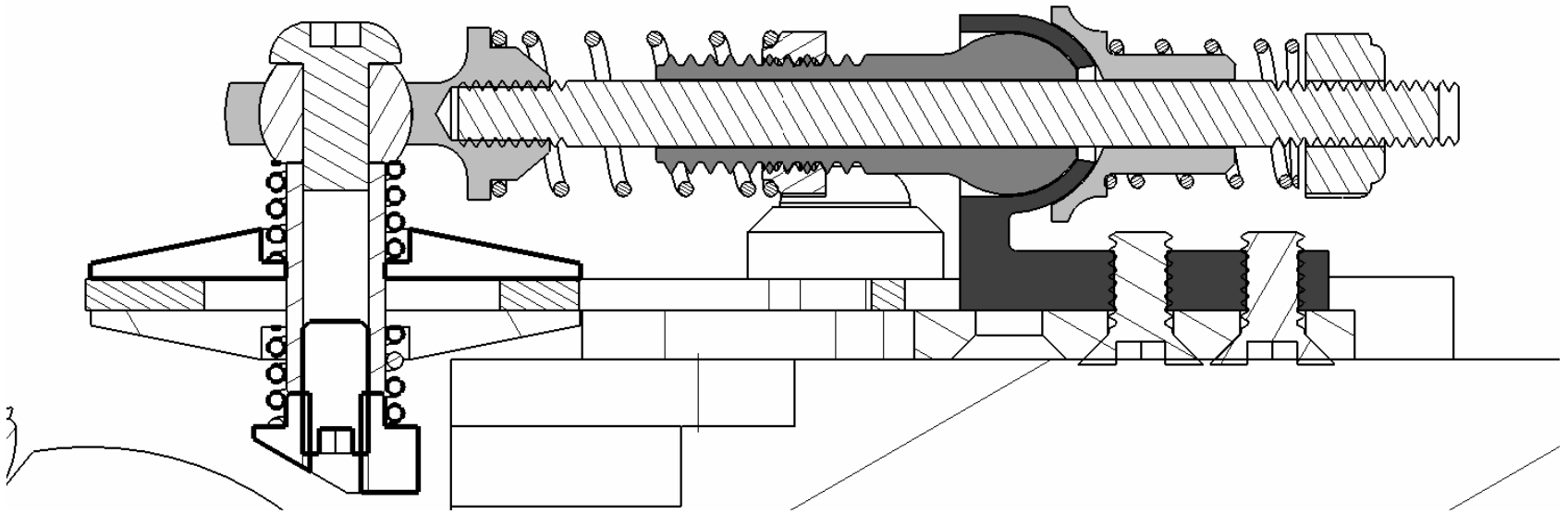

PN Racing Coil Over Spring Center Shock with  
Adjustable Negative Spring and Thru-Shaft Design