

# PNR2.5W Chassis

## INSTALLATION GUIDE

The following parts from the existing Kyosho MR03 chassis needs to be transferred to the new PNR2.5W Chassis

- Electronics (ASF, PN DSM2 or any others)
- Servo Motor
- Potential Meter
- Complete servo assembly (Housing, Servo Gears & Servo Saver)
- Power Switch

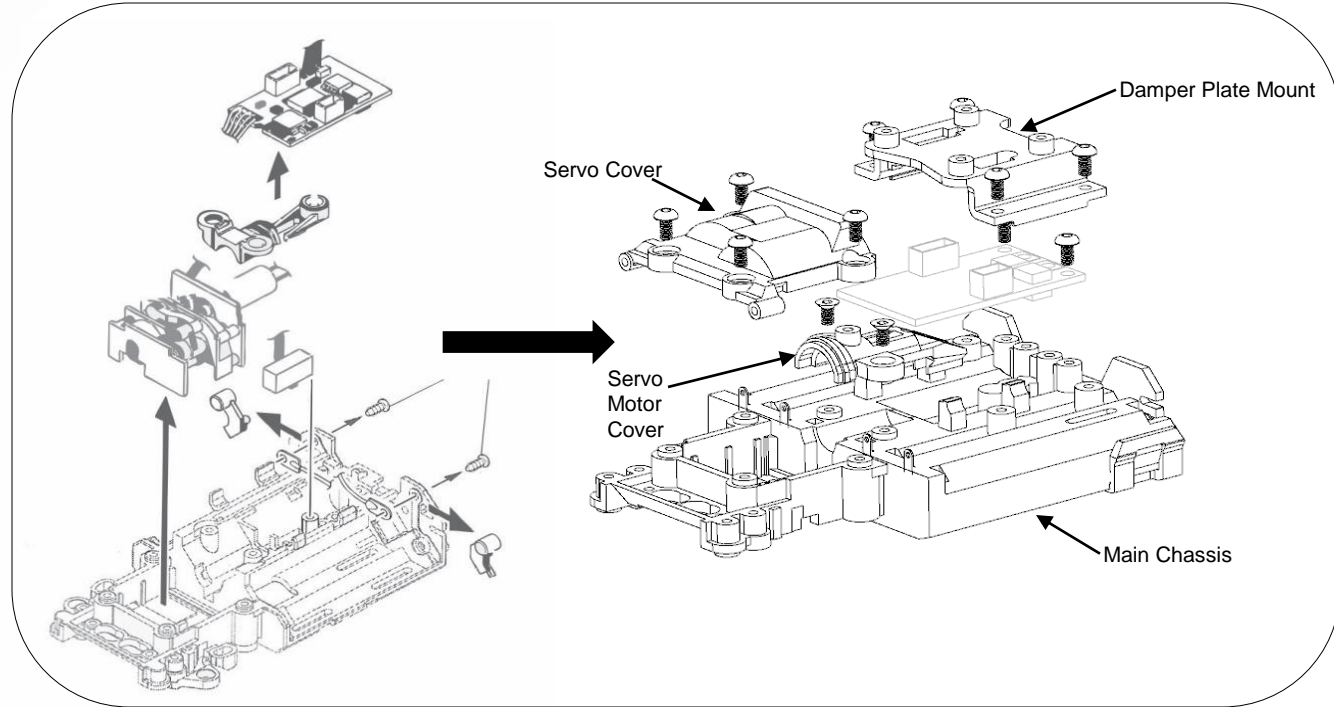

## PNR 2.5W WIRING DIAGRAM

Use the wires provided to wire up the chassis based on one of the following options

Cables Provided:

- 1 x Positive Wire (RED)
- 1 x Negative Wire (Black)
- 1 x Short Bridging Wire (White)
- 1 x Long Bridging Wire (White)

**NOTE: ELECTRONICS, SERVO ASSEMBLY**

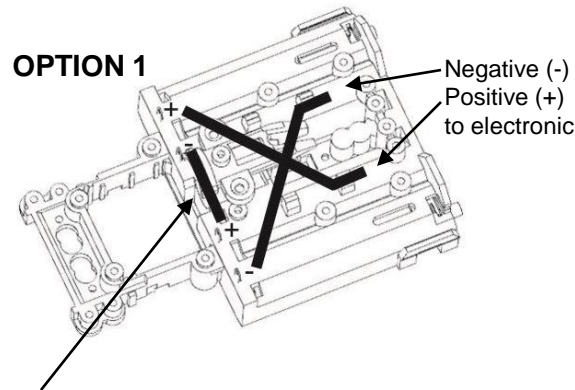

Bridge the internal Positive (+) & Negative (-) terminals together

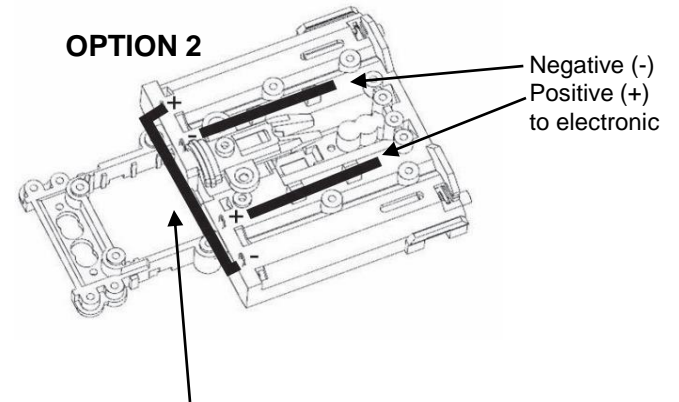

Bridge the external Positive (+) & Negative (-) terminals together

Shave off and flatten this portion to allow MR03VE board

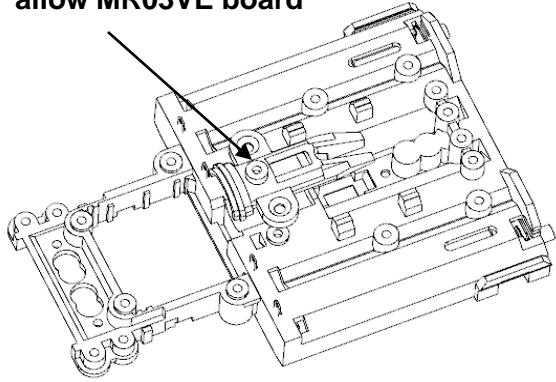

## INSTALLATION GUIDE FOR 94MM, 98MM, 102MM OR 106MM WHEEL BASE

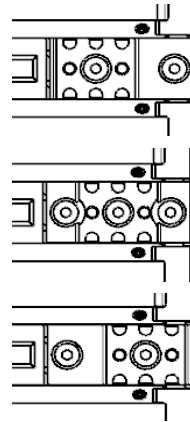

94/98mm Wheel Base  
(Using 94mm & 98mm  
Motor Mount)

102MM  
Wheel Base

106MM  
Wheel Base

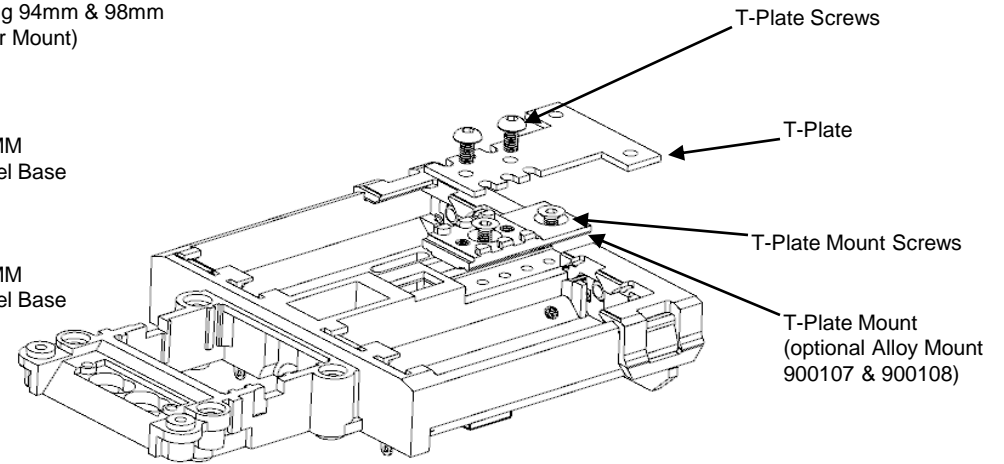

**NOTE: T-PLATE AND SCREWS ARE NOT INCLUDED**

## INSTALLATION GUIDE FOR BATTERY AND HOLDER

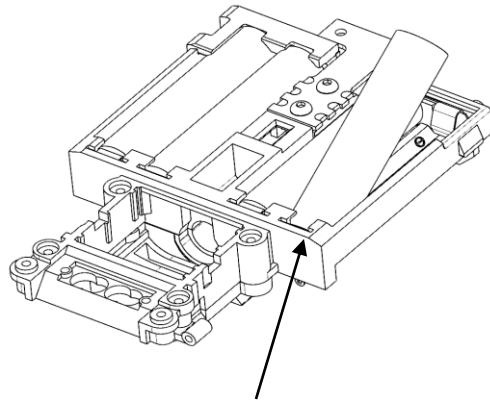

1. Insert battery into front  
of the chassis first

2. Insert battery holder below  
T-Plate Mount

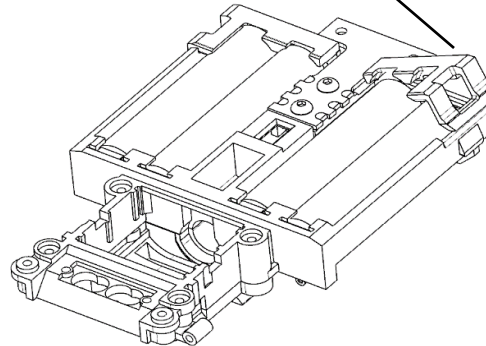

3. Push down battery clip to  
latch on chassis

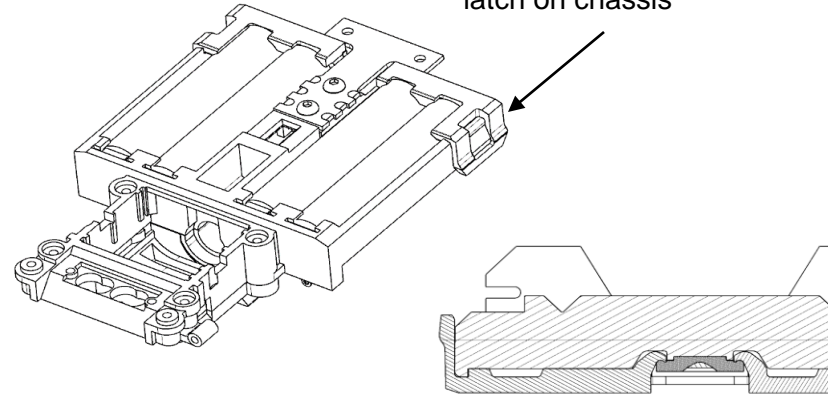

**NOTE : Diagram shows  
properly installed battery clips**